



Quick Reference Guide



Important Information For Users:

A Safety Information Sheet and this separate Quick Reference Guide (containing basic operating information) are provided with the V.A.C.Ultra™ Therapy Unit. This Quick Reference Guide is not intended to be a comprehensive manual. For additional information concerning the V.A.C.Ultra™ Therapy System, including detailed operating instructions, please consult the V.A.C.Ultra™ Therapy System User Manual and the treating physician.

A copy of the V.A.C.Ultra™ Therapy System User Manual has been provided to the ordering healthcare facility. For an additional copy, in the US visit www.kci1.com, www.vaculta.com or contact KCI at 1-800-275-4524. Outside the US, visit www.kci-medical.com.

Warning

Important Safety Information Accompanies This Device

Indications, Contraindications, Warnings, Precautions and other Safety Information are contained in the V.A.C.Ultra™ Therapy System Safety Information Sheet. This information sheet is included with the therapy unit and also included in V.A.C.Ultra™ Dressing cartons. Please consult the V.A.C.Ultra™ Therapy System User Manual and the Safety Information Sheet before applying V.A.C.® Therapy or V.A.C. VeraFlo™ Therapy. If there are questions, or if this information sheet is missing, immediately contact your local KCI representative.

Additional product information can be found at www.kci1.com (US) or www.kci-medical.com (outside the US).

As with all prescription medical devices, failure to follow product instructions or adjusting settings and performing therapy applications without the express direction and / or supervision of your trained clinical caregiver may lead to improper product performance and the potential for serious or fatal injury. For medical questions, please consult a physician. In case of medical emergency, immediately contact your local emergency services provider.

CAUTION: Federal law (US) restricts this device to sale or rental by or on the order of a physician.

The V.A.C.Ultra™ Negative Pressure Wound Therapy System (V.A.C.Ultra™ Therapy System) is an integrated wound therapy system that can deliver (1) V.A.C. VeraFlo™ Therapy or (2) V.A.C.® Therapy alone.

V.A.C. VeraFlo™ Therapy

1

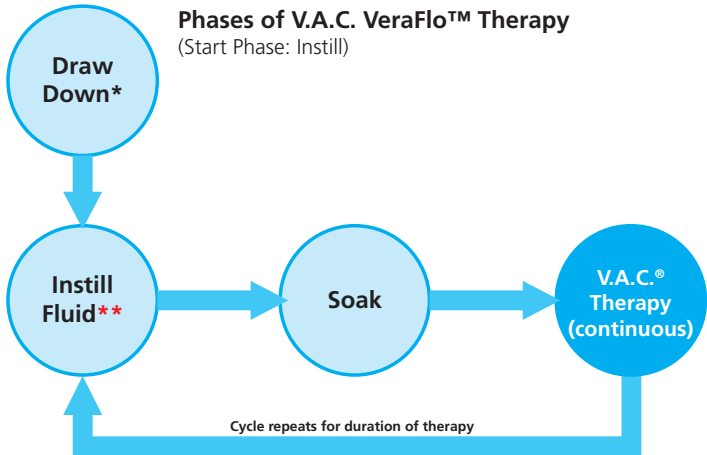

V.A.C. VeraFlo™ Therapy (Instillation) consists of negative pressure wound therapy (**V.A.C.® Therapy**) coupled with controlled delivery and drainage of topical wound irrigation treatment solutions and suspensions over the wound bed.

* Seal Check™ Leak Detector

** Fill Assist allows user to monitor initial wound fill by manually starting and stopping instillation to determine correct instill volume after dressing is applied. Once determined, this volume will be the set point for each subsequent instill phase of V.A.C. VeraFlo™ Therapy.

V.A.C.® Therapy

2

Mode



Not available if using
V.A.C. VeraFlo™ Therapy

Negative Pressure Profile



V.A.C.® Therapy consists of negative pressure wound therapy alone.

V.A.C. Ultra™ Therapy Unit Feature Identification

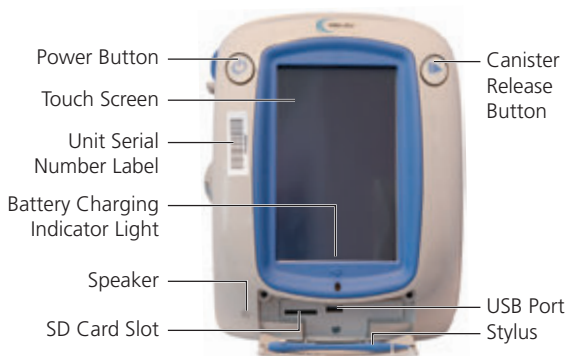

V.A.C. Ultra™ Therapy Unit - Front

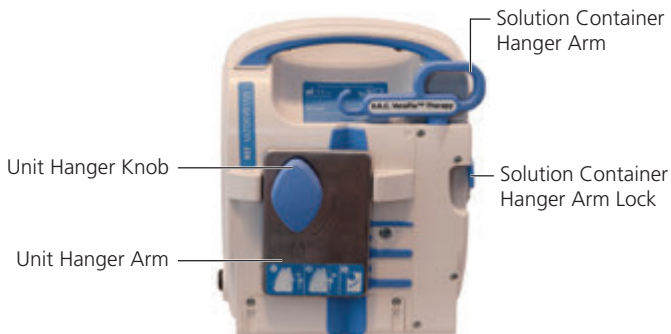

V.A.C. Ultra™ Therapy Unit - Back

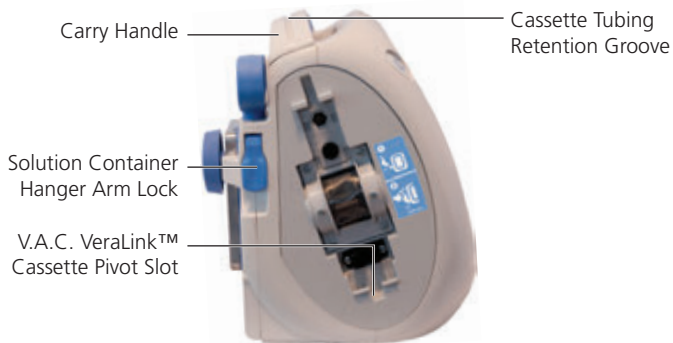

V.A.C.Ulta™ Therapy Unit - Left

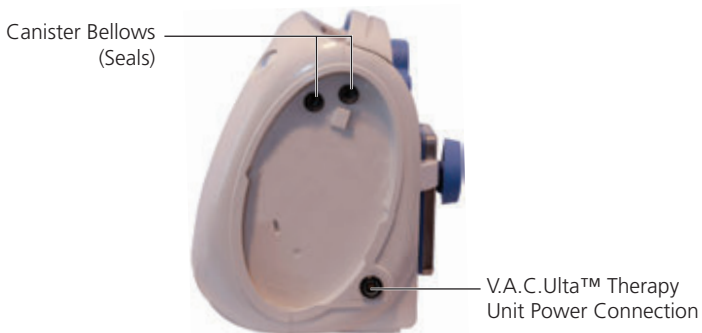

V.A.C.Ulta™ Therapy Unit - Right

Preparing the V.A.C. Ultra™ Therapy Unit for Use

Apply the dressing according to the instructions for use included in the V.A.C. Ultra™ Dressing cartons, then set up the therapy unit as follows.

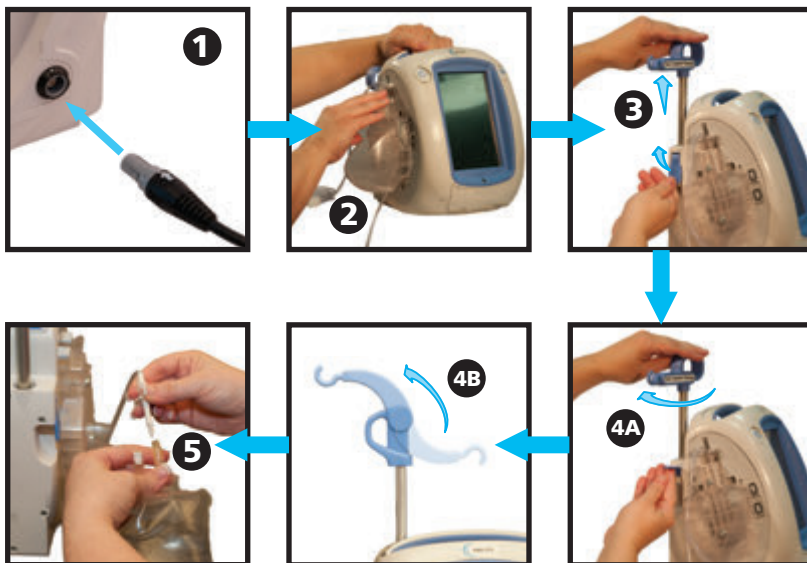

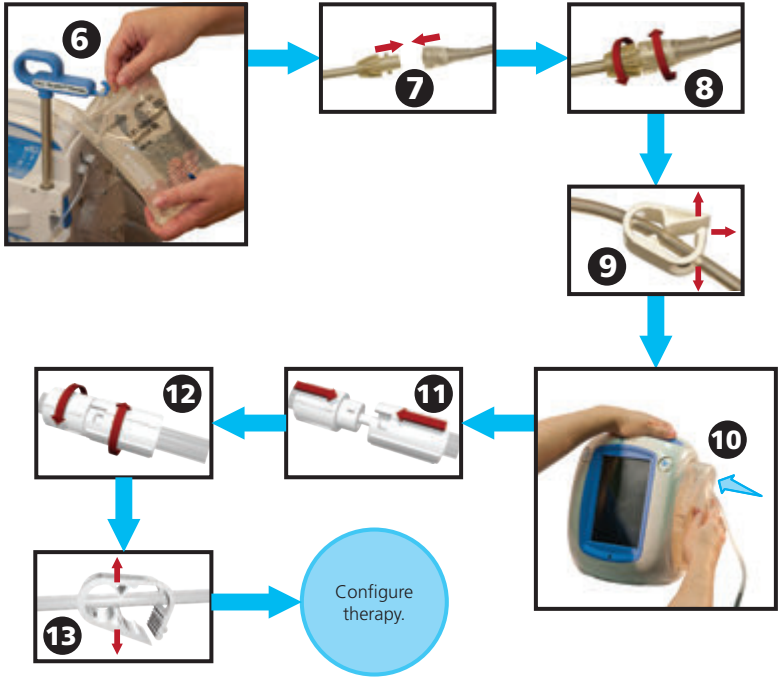

Refer to the V.A.C. Ultra™ Therapy System User Manual for more detailed information.

Common Touch Screen Buttons

Most screens have one or more common control buttons. These are:



Access Help screens



Select to activate Screen Guard

Select and hold to activate Settings Lock



Activate Night Mode



Confirm selection



Close pop-up screen



Cancel operation

Configure Therapy

Refer to the V.A.C. Ultra™ Therapy System User Manual for more detailed information.

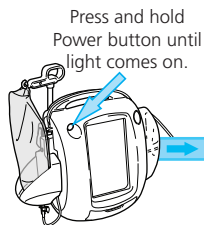

**Required unit
configuration for:**

V.A.C. VeraFlo™ Therapy:
500 mL or 1000 mL Canister
V.A.C. VeraLink™ Cassette

OR

V.A.C.® Therapy:
500 mL or 1000 mL Canister

Startup screen.

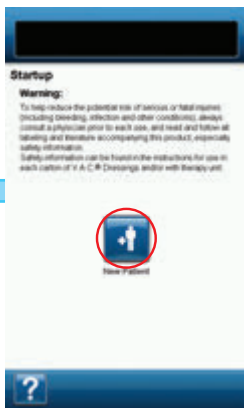

Select **New Patient**.

New Patient screen.



Enter Patient
Information, Select
OK.

**Availability dependent
on therapy unit
settings.**

NOTE: Screen shots are for representation only. Refer to the V.A.C. Ultra™ Therapy System User Manual for more detailed information.

Configure Therapy - V.A.C. VeraFlo™ Therapy

Choose Therapy screen.

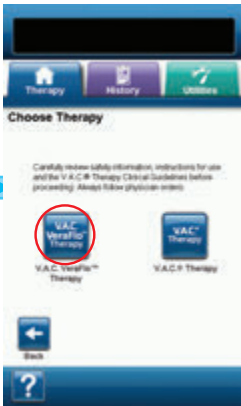

Select **V.A.C. VeraFlo™ Therapy**.

V.A.C. VeraFlo™ Settings screen.

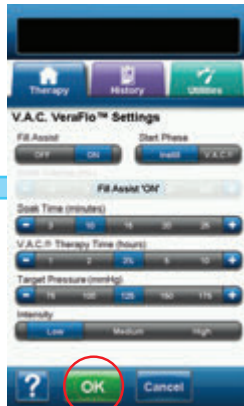

Configure V.A.C. VeraFlo™ Therapy. Select **OK**.

Confirm Settings screen.

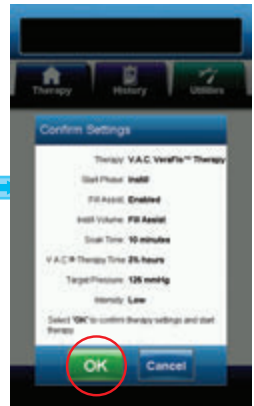

Select **OK** to confirm settings and begin therapy.

Settings displayed will vary depending on settings defined by user.

Configure Therapy - V.A.C.® Therapy

Choose Therapy screen.



Select **V.A.C.® Therapy**.

V.A.C.® Therapy Settings screen.

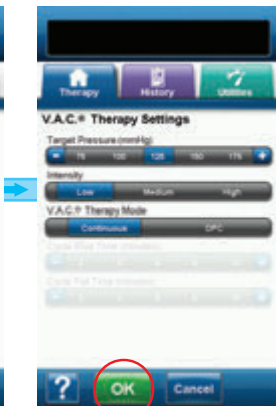

Configure V.A.C.® Therapy.
Select **OK**.

Confirm Settings screen.

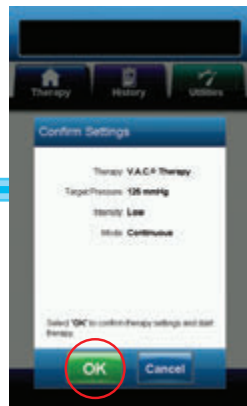

Select **OK** to confirm settings and begin therapy.

Settings displayed will vary depending on settings defined by user.

V.A.C. VeraFlo™ Therapy Home Screen



Refer to the Operation section of the V.A.C. Ultra™ Therapy System User Manual for more detailed information.

Therapy Settings - V.A.C. VeraFlo™ Therapy

From the [V.A.C. VeraFlo™ Therapy Home](#) screen, select **Therapy Settings** to continue to the [V.A.C. VeraFlo™ Settings](#) screen.

The screenshot shows the 'V.A.C. VeraFlo™ Settings' screen. At the top are three buttons: 'Therapy' (home icon), 'History' (calendar icon), and 'Utilities' (wrench icon). Below is the title 'V.A.C. VeraFlo™ Settings'. The settings are as follows:

- Fill Assist:** A toggle switch currently set to 'OFF'. Annotation: 'Set Fill Assist Default = ON'.
- Start Phase:** Two buttons, 'Instill' and 'V.A.C.®'. 'Instill' is selected. Annotation: 'Start Phase Default = Instill'.
- Instill Volume (mL):** A slider with values 10, 32, 65, 150, and 300. The slider is positioned at 10. Annotation: 'Instill Volume Default = 10'.
- Soak Time (minutes):** A slider with values 3, 10, 15, 20, and 25. The slider is positioned at 10. Annotation: 'Set Soak Time Default = 10'.
- V.A.C.® Therapy Time (hours):** A slider with values 1, 2, 3 1/2, 5, and 10. The slider is positioned at 3 1/2. Annotation: 'Set V.A.C.® Therapy Time Default = 3 1/2'.
- Target Pressure (mmHg):** A slider with values 75, 100, 125, 150, and 175. The slider is positioned at 125. Annotation: 'Set Target Pressure Default = 125'.
- Intensity:** A slider with three positions: 'Low', 'Medium', and 'High'. 'Low' is selected. Annotation: 'Set Intensity Default = Low'.

At the bottom are three buttons: a 'Help' button with a question mark icon, an 'OK' button, and a 'Cancel' button. Annotations: 'OK to accept settings' points to the OK button, and 'Cancel to return to Home screen' points to the Cancel button.

Refer to the Operation section of the V.A.C. Ultra™ Therapy System User Manual for more detailed information.

V.A.C.® Therapy Home Screen

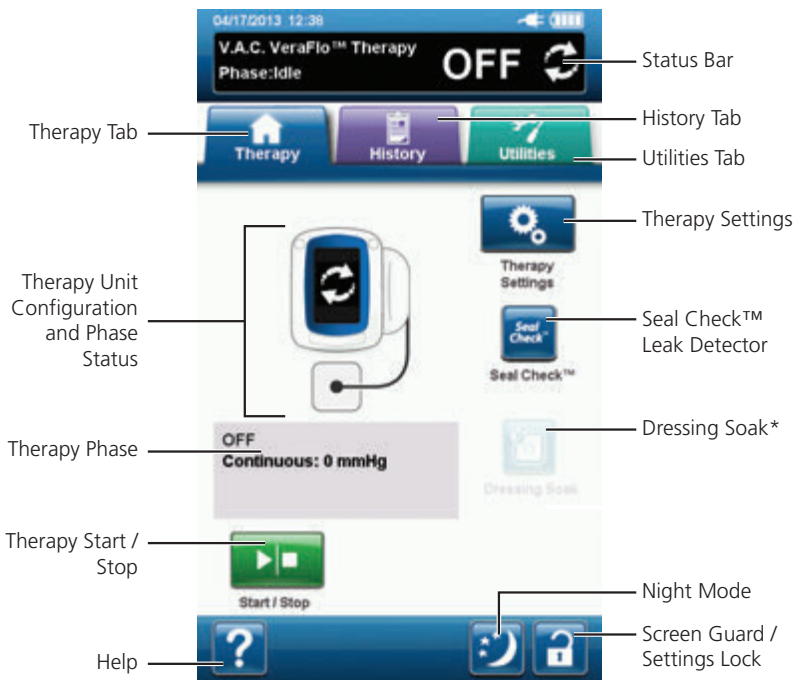

Refer to the Operation section of the V.A.C. Ultra™ Therapy System User Manual for more detailed information.

* V.A.C. VeraLink™ Cassette must be installed for **Dressing Soak** to be available.

Therapy Settings - V.A.C.® Therapy

From the **V.A.C.® Therapy Home** screen, select **Therapy Settings** to continue to the **V.A.C.® Therapy Settings** screen

The screenshot shows the **V.A.C.® Therapy Settings** screen. At the top are three navigation buttons: **Therapy** (home icon), **History** (document icon), and **Utilities** (wrench icon). Below these is the title **V.A.C.® Therapy Settings**. The settings are as follows:

- Target Pressure (mmHg)**: A slider with values 75, 100, 125, 150, and 175. The value 125 is selected. Callout: "Set Target Pressure Default = 125".
- Intensity**: A slider with three positions: **Low**, **Medium**, and **High**. **Low** is selected. Callout: "Set Intensity Default = Low".
- V.A.C.® Therapy Mode**: A slider with two positions: **Continuous** and **DPC**. **Continuous** is selected. Callout: "Set V.A.C.® Therapy Mode Default = Continuous".
- Cycle Rise Time (minutes)**: A slider with values 2, 3, 4, 6, 8, and 10. The value 3 is selected. Callout: "When DPC is selected, set Cycle Rise Time Default = 3".
- Cycle Fall Time (minutes)**: A slider with values 2, 3, 4, 6, 8, and 10. The value 3 is selected. Callout: "When DPC is selected, set Cycle Fall Time Default = 3".

At the bottom are three buttons: **?** (Help), **OK** (green), and **Cancel** (blue). Callouts for these buttons are:

- ?**: "Help"
- OK**: "OK to accept settings"
- Cancel**: "Cancel to return to Home screen"

Refer to the Operation section of the V.A.C. Ultra™ Therapy System User Manual for more detailed information.

Seal Check™ Leak Detector

The Seal Check™ Leak Detector is used to help find negative pressure leaks.



Access the Seal Check™ Leak Detector from the **Home** screen. The Seal Check™ Leak Detector will also automatically run during the initial Drawdown phase of V.A.C. VeraFlo™ Therapy and once V.A.C.® Therapy has been initiated.

Most leaks occur:

- where the drape meets the skin.
- where the V.A.C. VeraT.R.A.C.™ Pad, V.A.C. VeraT.R.A.C. Duo™ Tube Set pads or SensaT.R.A.C.™ Pad are attached to the drape.
- at tubing connections.
- if the canister is not fully seated to the therapy unit.

Seal Check™ Leak Detector Defaults

- Seal Audio default is set to OFF.

Drawdown can take up to two minutes and thirty seconds to establish seals. During this drawdown, observe the dressing for leaks.



The Establishing Dressing Seal timer is set for two minutes and thirty seconds; however, once the V.A.C.Ulta™ Therapy Unit has reached target pressure and determined that the dressing air leaks are small enough to continue V.A.C. VeraFlo™ Therapy, **OK** will highlight at the bottom of the screen. Select **OK** to continue to the **Home** screen or **Fill Assist** screen depending on therapy settings.

The Seal Check™ Leak Detector time is designed to help minimize the potential for leaks by pulling the drape against the skin and allowing the adhesive time to cure.

Ensure that disposable changes are recorded using **Log** tool.

Fill Assist

Fill Assist helps the user determine the correct instill volume to use during the instill phase of a V.A.C. VeraFlo™ Therapy cycle.

It allows the user to monitor initial wound fill by manually starting and stopping instillation to determine the correct instill volume for each instill phase. If correct instill volume is already known, select Fill Assist **OFF** to use the Instill Volume selection bar.

Using Fill Assist

NOTE: After confirming settings by selecting **OK**, negative pressure is applied to establish dressing seal (**Seal Check™ Leak Detector** screen). **Fill Assist** screen will appear (if selected) in approximately three minutes.



1. Select **Start / Stop** on **Fill Assist** screen to begin delivering solution to wound.

2. **Watch the wound as it fills with solution.**



3. Select **Start / Stop** again to stop solution delivery when suitable fill volume has been delivered to the wound bed.



4. Select **OK** to confirm the determined fluid volume as displayed on the **Fill Assist** screen and return to the **Home** screen. The therapy unit will then begin the soak phase.



5. If wound has been over-filled, solution needs to be removed, or Fill Assist needs to be restarted, select **Reset** to remove solution from the wound and return to the **Fill Assist** screen.

Test Cycle

Use to complete an abbreviated V.A.C. VeraFlo™ Therapy cycle. Each phase of the cycle will be tested to ensure system is set up and functioning correctly.



1. Select **Test Cycle** from the **Home** screen.
2. Once Test Cycle is complete, select **Exit** to go to V.A.C.® Therapy phase.

Dressing Soak



Use to soak the dressing with solution in preparation for a dressing change. Refer to the V.A.C.Ultra™ User Manual for more detailed information.

Alerts and Alarms

Refer to the Alerts and Alarms section of the V.A.C.Ultra™ Therapy System User Manual or select **Help** for more detailed information.

Alerts and Alarms appear on the touch screen and are accompanied by a repeating audible tone.



Select **Audio Pause** to silence the audible tone for two minutes.



Select **Help** for more information regarding alarm resolution.

If alarm conditions cannot be resolved, contact KCI.

Low Priority Alarm / Alert Condition - Displayed on the touch screen when the V.A.C.Ultra™ Therapy Unit detects a condition that requires attention. Alerts will be accompanied by a repeating audible tone approximately every 20 seconds (two beeps).

Battery Low Alert

V.A.C.® Therapy Blockage Alert

V.A.C. VeraFlo™ Blockage Alarm (Therapy Interrupted)

V.A.C. VeraLink™ Not Engaged Alarm

Solution Bag / Bottle Empty Alarm

Fill Assist Inactive Alarm

Internal Temperature Alarm

Medium Priority Alarm Condition - Displayed on the touch screen when the V.A.C.Ultra™ Therapy Unit detects a condition that requires prompt attention in order to ensure the prescribed therapy is being delivered. Alarms will be accompanied by a repeating audible tone approximately every two seconds (three beeps) and a flashing screen title.

Battery Critical Alarm

Canister Full Alarm (Therapy Interrupted)

Canister Not Engaged Alarm

V.A.C.® Therapy Leak Alarm

V.A.C.® Therapy Leak Alarm (Therapy Interrupted)

V.A.C. VeraFlo™ Pressure Deviation Alarm (Therapy Interrupted)

V.A.C.® Therapy Blockage Alarm (Therapy Interrupted)

V.A.C.® Therapy Low Pressure Alarm (Therapy Interrupted)

System Error Alarm

Therapy Inactive Alarm

Customer Contact Information

For questions regarding this product, supplies, maintenance, or additional information about KCI products and services, please contact KCI or a KCI authorized representative, or:

In the US call 1-800-275-4524 or visit www.kci1.com or www.vaculta.com
KCI USA, Inc. 12930 IH 10 West San Antonio, TX 78249

Outside the US visit www.kci-medical.com



KCI USA, Inc.
12930 IH 10 West
San Antonio, TX 78249 USA
1-800-275-4524
www.kci1.com
www.vaculta.com



KCI Medical Products (UK), Ltd.
11 Nimrod Way
Wimborne, Dorset
BH21 7SH
United Kingdom
www.kci-medical.com

All trademarks designated herein are proprietary to KCI Licensing, Inc., its affiliates, and / or licensors.

© 2013 KCI Licensing, Inc. All rights reserved. 350161 Rev C 9/2013